

REV.	DESCRIPTION	DRAWN	CHECKED	APPROVED
A	NEW RELEASE	YCH 06/27/08'	~	

Female Terminal

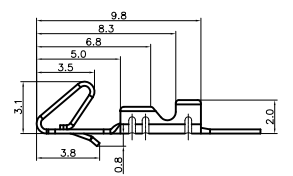

Female Terminal

Wire Range		O.D of Wire	
Section Area (mm ²)	AWG#	mm	
0.2~0.75	28~18	1.2~2.1	

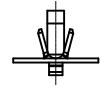

Female Housing

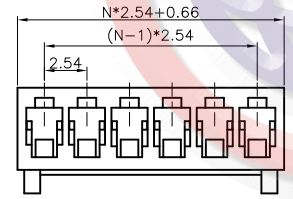
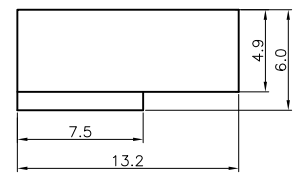

NOTES:

1. MAIN SPECIFICATIONS

- . Housing material: NYLON 66
- . Contact material: Copper alloy
- . Wires range: AWG#28~#18
- . Rated voltage: 250V
- . Rated current: 1A
- . Contact resistance: ≤ 30mΩ
- . Insulation resistance: ≥ 1000MΩ
- . Withstanding voltage: 500V,AC 1 minute
- . Temperature range: -25 ~ +85°C

2. PRODUCT NUMBER CODE:

DS1070 - X X X X X X

- Bend Type(R/A Only)
 - A: Type A
 - B: Type B
- Contact Plating
 - 6: Tin
- Housing Color
 - V: Ivory
 - T: Transparent
 - W: White
- Mounting type
 - C: Crimp
 - R: Right Angle
 - V: V/T type
- Connector type
 - M: Male
 - F: Female
- No.of contact
 - 2 to 20

Male Right Angle

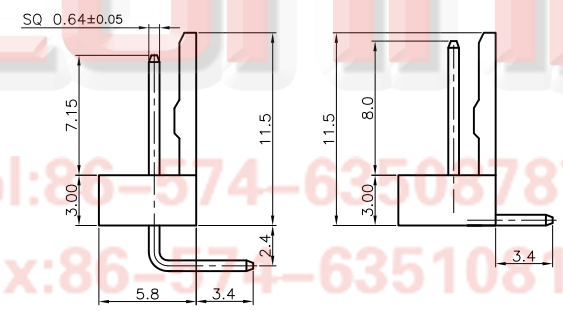
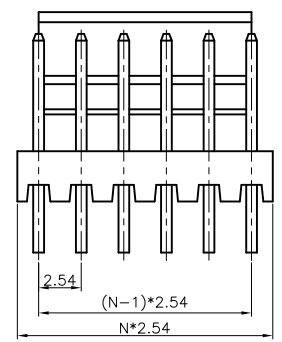

Type A

Type B

Male V/T TYPE

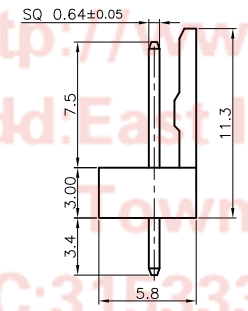
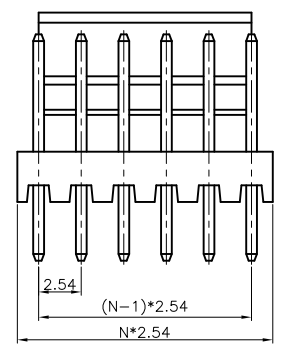

N=NO. OF CONTACTS

Tel:86-574-63505787
 Fax:86-574-63510517
 E-mail:sale@connfly.com
 http://www.connfly.com
 Add:East Industry Zone KuangYan
 Town Cixi Ningbo China
 P.C:315333

GENERAL TOLERANCE		ANGLE TOLERANCE		PROJECTION	TITLE
X.	±0.60	X.	±5°	mm	P.C.B CONNECTOR Pitch 2.54mm
.X	±0.38	.X	±3°	A4	
.XX	±0.25	.XX	±2°	SHEET SIZE	SERIES DS1070
DRAWING TYPE		CUSTOMER		晨翔电子有限公司 CONNFLY CONNFLY ELECTRONIC CO., LTD	
SCALE		1:1 SHEET 1 OF 1			
DRAWING NO.		C-DS1070-XXXXXX			